



# FT-CLM Cable Column



## STANDARD FEATURES

- ✓ 150lb. weight stacks with ten 5lb. and ten 10lb. plates.
- ✓ Adjustable to 17 different heights.
- ✓ 2:1 cable ratio.
- ✓ Integrated foot block for seated row exercises.
- ✓ Chrome steel stirrup handle.

## OPTIONAL FEATURES

- ✓ Steel shrouds powder coated and clear coated for a mar resistant and lustrous finish.
- ✓ Standard 150 lb. tiered weight stack is upgradeable in 50 lb. increments to 300 lbs.

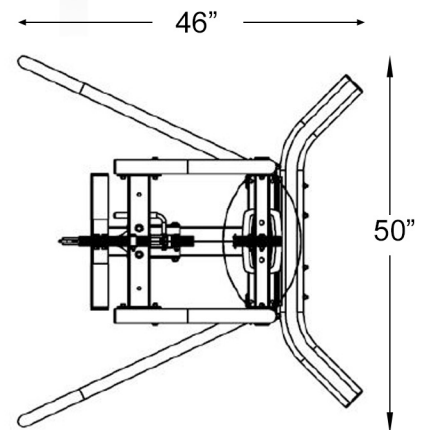

46" L x 50" W x 94.17" H  
117cm x 127cm x 239cm

Lifetime limited warranty on frame, welds, and weights, 3 years on bearings, guide rods, cams, and pulleys, 1 year on cables.

See [www.inflightfitness.com](http://www.inflightfitness.com) for our entire line of commercial fitness equipment.